



DATE
612/759
22 JUN 2012

John Booth

Arboricultural Consultants Ltd

*John A Booth MBA, MSc, FICFor, CEnv, FArborA, MIEEM,
MEWI, DipArb(RFS), CUEW, LCGI(Hort), ND Arb.
Director & Principal Consultant*
Chartered Arboriculturist & Chartered Environmentalist

Tree Inspection Report

at

**Patchetts
Broadway**

for and on behalf of

Mr P Ellse

March 2012

242 Highfields Park
Broadway
Derby
DE22 1JY
Tel (01332) 556307
Mobile: 07783 968714
Email: info@jabooth.co.uk
Web: www.jabooth.co.uk



EWI

MEWI

Contents

- 1 Introduction**
 - 1.1 Author's Qualifications and Experience
 - 1.2 Background & Brief
 - 1.3 Documents and Information Provided
 - 1.4 Scope
- 2 Site Visit and Observations**
 - 2.1 Site Visit
 - 2.2 Tree Survey Methodology
- 3 Other Considerations**
 - 3.1 Trees Subject to Statutory Controls
 - 3.2 Trees and Wildlife
 - 3.3 Implementation of Tree Works
- 4 References**
- 5 Tree Survey Schedule & Plan**
- 6 Appendices**
 - Appendix 1 – Curriculum vitae
 - Appendix 2 – The Recognition of Hazardous Trees

All rights in this report are reserved. No part of it may be reproduced or transmitted, in any form or by any means, electronic, mechanical, photocopying, recording or otherwise, or stored in any retrieval system of any nature, without written permission. Its content and format are for the exclusive use of the addressee in dealing with the subject matter. It may not be sold, lent, hired out or divulged to any third party not directly involved in the matter concerned without written consent.

© John Booth Arboricultural Consultants Ltd 2012

1 INTRODUCTION

1.1 *Author's Qualifications and Experience:* John Booth is a Chartered Arboriculturist, a Chartered Environmentalist, a member of the Expert Witness Institute, a Fellow, Registered Consultant and past national Chairman of the Arboricultural Association, a Fellow of the Institute of Chartered Foresters and a member of the Institute of Ecology and Environmental Management. He has over twenty five years experience of arboriculture and amenity tree management and has written papers published in respected journals such as the International Journal of Urban Forestry. He is trained in the use of the Quantified Tree Risk Assessment (QTRA) methodology and is a Bond Solon/Cardiff University certificated Expert Witness. A full CV can be found at Appendix 1.

This report is based on his site observations and the information provided.

1.2 *Background and Brief:* Peter Ellse (the client) sought advice regarding the management of trees located on land comprising part of a site belonging to Patchetts, Broadway, specifically those trees adjacent to the rear boundaries of residential properties on Highfields Park Drive; No's 37 to 60 as identified in our survey report of February 2009 (the site). The instruction was to undertake a tree inspection and to make recommendations regarding the need for any remedial works considered necessary to manage any identified hazards. All tree survey data and recommendations are recorded in the Tree Survey Schedule.

Whilst expert opinion and inspection might provide more assurance than a 'lay' inspection, basic inspection by those persons regularly present at the site can assist in the identification of hazardous trees. General guidance on common tree hazards can be found at Appendix 2.

1.3 *Documents & Information Provided:* A topographical survey of the site was provided.

1.4 Scope:

1.4.1 The findings and recommendations contained within this report are, assuming its recommendations are observed, valid for a period of twelve months from the date of survey; trees are living organisms subject to change – best practice dictates they are inspected regularly for reasons of safety.

1.4.2 Whilst every effort has been made to detect defects within the trees inspected, no guarantee can be offered. The recommendations given are intended to reduce the likelihood of tree collapse but absolute safety is not a realistic goal; even apparently sound trees can fail. All recommendations are made in the context of the site's current usage; any change will dictate a re-inspection. It is further recommended that the subject trees are inspected regularly by a Chartered Arboriculturist.

1.4.3 Where trees were clad with ivy (*Hedera helix*) or where dense twig growth obscured the tree trunk, this was recorded in the Tree Survey Schedule. The inspection of such trees is impeded; ivy and twig growth should be removed and a further inspection carried out.

1.4.4 This report has been prepared for the sole use of the client. Any third party referring to this report or relying on the information contained herein does so entirely at his or her own risk.

1.4.5 The expertise of the author of this report is ARBORICULTURE, any non-arboricultural references made within this report are made as a lay person.

2 SITE VISIT AND OBSERVATIONS

2.1 Site Visit: An unaccompanied site visit was carried out on 9 March 2012 by John Booth who conducted a 'walk over' survey of the entire site. The weather at the time of the survey was dry and visibility was adequate for the purposes of the visit.

2.2 Tree Survey Methodology: An inspection of the subject trees, whose approximate location is shown on the Tree Survey Plan, was conducted visually

from the ground using 'Visual Tree Assessment' (VTA) techniques. VTA is a methodology, employed by arboriculturists, to evaluate the structural integrity of a tree, relying on observation of a trees biomechanical and physiological features; this is the method generally adopted and is appropriate in this instance. Information recorded in the Tree Survey Schedule includes:

2.2.1 Species – the species identification is based on visual observations and the common English name of what the tree appeared to be is listed first, with the botanical name after in brackets.

2.2.2 Tree Heights – are estimated in metres.

2.2.3 Age Class – recorded as follows:

- Yng - Young tree; <1/3 of normal life expectancy
- Mid - Middle aged tree; between 1/3 & 2/3 normal life expectancy
- Mat - Mature tree; has attained optimum stature
- OM - Over Mature tree; declining

2.2.4 The Condition of each tree is categorised thus:

- A - Good
- B - Fair
- C - Poor
- D - Very poor/Dead

2.2.5 Comments & Recommendations – remedial tree surgery works required.

2.2.6 Priority – In order to make best use of resources priorities have been allocated to the works recommended. Priorities are given on the basis of:

- **High Priority (H)** – Trees with large defects, in high value target areas, likely to fail in the short term requiring attention as soon as can be practically arranged.
- **Medium Priority (M)** – Trees requiring attention as soon as resources permit following the execution of High Priority works.

- **Low Priority – (L)** Trees largely removed from persons or property or with infrequent target and which have only minor defects, works in the interests of sound arboricultural practice.

It is for site managers to determine within what time-frame recommended works are implemented, this report seeks only to advise as to priorities; how swiftly each priority is attended to will be influenced by the resources at the disposal of the client.

3 OTHER CONSIDERATIONS

3.1 Trees Subject to Statutory Controls: It is understood that the trees are subject to a Tree Preservation Order (TPO). With regard to trees subject to TPO's it is a requirement that a standardized application form is used; this form is available from the LPA.

3.2 Trees and Wildlife: Trees play host to nesting birds many of which are protected by law. All British bat species are also protected and many can be found in trees. Great care needs to be taken to avoid disturbance and consideration should be given to the timing of tree works in order to avoid such. Where the presence of protected species is suspected, Natural England should be contacted for advice and a Licensed Bat Handler must be appointed.

4 REFERENCES

- British Standard 3998:2010 '*Recommendations for Tree Work*'.
- DCLG (2000) Tree Preservation Orders – A Guide to the Law and Good Practice
- Mattheck, C. Breloer H., (1994) *The Body Language of Trees*, Forestry Commission.
- Mattheck, C. (2007), *Updated Field Guide for Visual Tree Assessment*
- Lonsdale D., (1999), Principles of Tree Hazard Assessment and Management, DETR
- Lonsdale D., (2000), '*Hazards From Trees – A General Guide*', Forestry Commission, Edinburgh

5 Tree Survey Schedule

Tree No	Species	Ht (m)	Age Class	Cond.	Recommendations	Priority
37	Lime - stump (<i>Tilia</i> sp)	0	-	-	-	-
38	Yew (<i>Taxus baccata</i>)	4	Yng	B	None at this moment in time	-
39	Elm (<i>Ulmus</i> sp)	6	Yng	D	Fell	High
40	Ash - stump (<i>Fraxinus excelsior</i>)	-	-	-	-	-
40a	Horse Chestnut - stump (<i>Aesculus hippocastanum</i>)	-	-	-	-	-
41	Sycamore - stump (<i>Acer pseudoplatanus</i>)	-	-	-	-	-

Tree No	Species	Ht (m)	Age Class	Cond.	Recommendations	Priority
42	Corsican Pine (<i>Pinus nigra</i> spp <i>Laricio</i>)	22	Mat	B/C	Remove storm damaged limb	
43	Yew (<i>Taxus baccata</i>)	10	Yng	B	None at this moment in time	-
44	Sycamore (<i>Acer pseudoplatanus</i>)	7	Yng	B	None at this moment in time	-
45	Elm (<i>Ulmus</i> sp)	11	Mid	D	Fell	High
46	Hawthorn (<i>Crataegus monogyna</i>)	9	Mat	C	Fell	High
47	Ash (<i>Fraxinus excelsior</i>)	20	Mid	B	None at this moment in time	-
48	Yew (<i>Taxus baccata</i>)	8	Yng	B	None at this moment in time	-

Tree No	Species	Ht (m)	Age Class	Cond.	Recommendations	Priority
49	Norway Maple (<i>Acer platanoides</i>)	14	Yng	B	None at this moment in time	-
50	Corsican Pine (<i>Pinus nigra</i> spp <i>Laricio</i>)	21	Mid	B	None at this moment in time	-
51	Ash (<i>Fraxinus excelsior</i>)	22	Mat	B	None at this moment in time	-
52	Norway Maple (<i>Acer platanoides</i>)	16	Mid	B	None at this moment in time	-
53	Hawthorn (<i>Crataegus monogyna</i>)	12	Mid	B	None at this moment in time	-
54	Norway Maple (<i>Acer platanoides</i>)	17	Yng	B	None at this moment in time	-
55	Ash (<i>Fraxinus excelsior</i>)	21	Mid	B	None at this moment in time	-

Tree No	Species	Ht (m)	Age Class	Cond.	Recommendations	Priority
56	Elm (<i>Ulmus</i> sp)	10	Yng	B	Prune to clear telegraph pole by 1m	Low
57	Ash (<i>Fraxinus excelsior</i>)	22	Mid	B	Remove deadwood & lowest secondary limb over garden of 1 Highfields Park Drive	Low
58	Corsican Pine (<i>Pinus nigra</i> spp <i>Laricio</i>)	19	Mid	B	None at this moment in time	-
59	Corsican Pine (<i>Pinus nigra</i> spp <i>Laricio</i>)	22	Mid	B	None at this moment in time	-
60	Corsican Pine (<i>Pinus nigra</i> spp <i>Laricio</i>)	22	Mid	D	Fell	High
63	Lime (<i>Tilia</i> sp)	22	Mid	C	Large cavity in main stem, bleeding canker – Fell & Replant	High

Tree Survey Plan

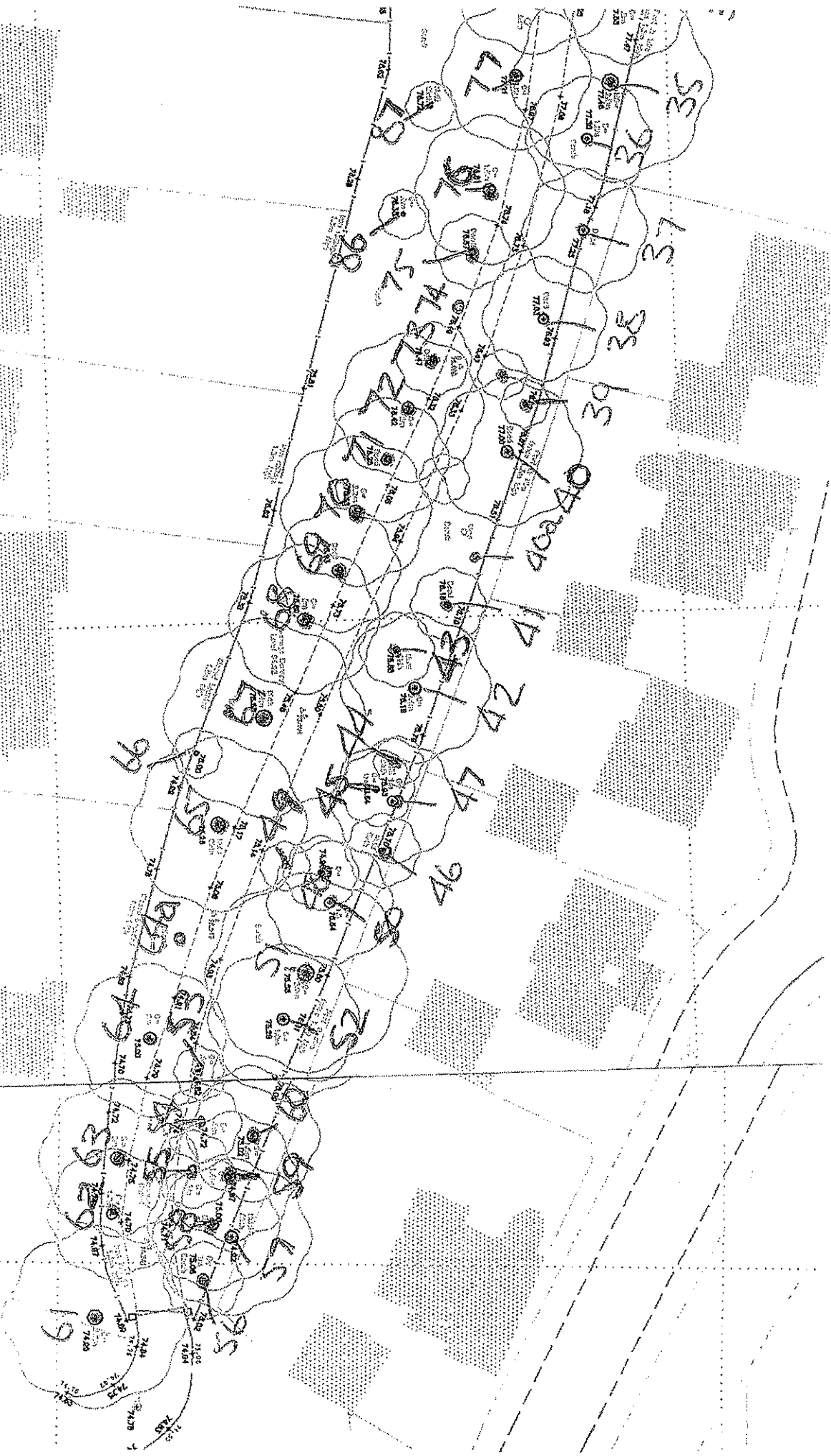

6 APPENDICES

Appendix 1: Curriculum Vitae

John Booth MBA, MSc, FICFor, CEnv, FArborA, MEWI, MIEEM, DipArb(RFS), CUEW, LCGI(Hort), NDArb

PROFESSIONAL QUALIFICATIONS

Sheffield/Hallam University, MSc in Environmental Management (Distinction), 2005-2006
Nottingham Trent/Derby Universities, Masters in Business Administration (MBA), 2002-2005
Merrist Wood College, RFS Professional Diploma in Arboriculture, 1992-1993
Merrist Wood College, National Diploma in Arboriculture (Distinction) (B Tec), 1987-1990
Cardiff University, Expert Witness Certificate, 2007
Lantra Certificate – Professional Tree Inspection, 2007

CAREER

2007 - Director of Sylvanus Arboricultural Consultants Ltd. (www.jabooth.co.uk)
1994 – 2007: Arboricultural Manager for Derby City Council.
1990 – 1994 – Tree & Landscape Officer for Wycombe DC
1988 – 1989 – Assistant Arboricultural Officer for Bolton MBC
1981 – 1987 – Arborist for Bolton MBC

CONTINUING PROFESSIONAL DEVELOPMENT (CPD)

The maintenance of an active CPD record is a strict membership requirement of the following professional organisations to which I subscribe –

- The Arboricultural Association
- The Institute of Chartered Foresters
- The Institute of Expert Witness's
- The Institute of Ecology and Environmental Management

MEMBERSHIP OF PROFESSIONAL BODIES

Fellow of the Institute of Chartered Foresters
Chartered Environmentalist
Chartered Arboriculturist
Fellow, past National Chair, Trustee and Registered Consultant of the Arboricultural Association
Member of Institute of Ecology and Environmental Management
Licentiate of City & Guilds Institute
Past Assessor for the Professional Diploma in Arboriculture

PUBLICATIONS

Numerous articles and papers in academic journals and trade literature.

The Recognition of Hazardous Trees

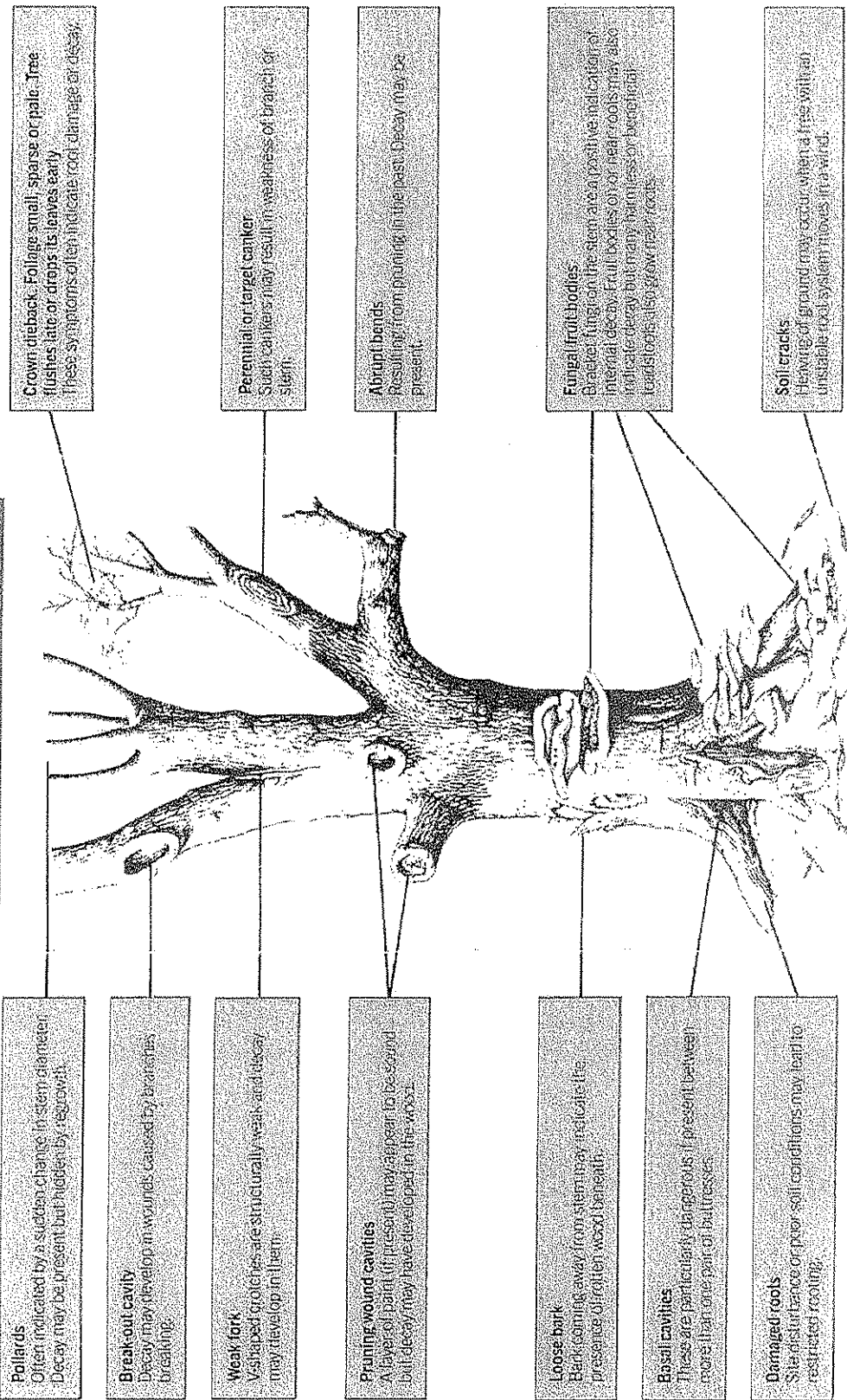



John Booth

Arboricultural Consultants Ltd

*John A Booth MBA, MSc, FICFor, CEnv, FARborA, MIEEM,
MEWI, DipArb(RFS), CUEW, LCGI(Hort), NDArb.*

Director & Principal Consultant

Chartered Arboriculturist & Chartered Environmentalist

242 Highfields Park

Broadway

Derby

DE22 1JY

Tel (01332) 556307

Mobile: 07783 968714

Email: info@jabooth.co.uk

Web: www.jabooth.co.uk